



The Causeway

Darlington DL1 1EN

By Auction £115,000





This footer paragraph is an example only and should not be relied upon as complying with current legislation. These particulars, whilst believed to be accurate are set out as a general outline only for guidance and do not constitute any part of an offer or contract. Intending purchasers should not rely on them as statements of representation of fact, but must satisfy themselves by inspection or otherwise as to their accuracy. No person in this firms employment has the authority to make or give any representation or warranty in respect of the property.



This footer paragraph is an example only and should not be relied upon as complying with current legislation. These particulars, whilst believed to be accurate are set out as a general outline only for guidance and do not constitute any part of an offer or contract. Intending purchasers should not rely on them as statements of representation of fact, but must satisfy themselves by inspection or otherwise as to their accuracy. No person in this firms employment has the authority to make or give any representation or warranty in respect of the property.



The Causeway

Darlington DL1 1EN



- Two Bedroom Bungalow
- Close to Amenities

- Off street Parking
- Council Tax Band B

- No Onward Chain
- EPC Rating E

Being Sold via Secure Sale online bidding. Terms & Conditions apply. Starting Bid £120,000

This two bedroom semi detached bungalow is located in the Eastbourne area of town. The property has good size living accommodation with a extended fitted kitchen and two good size double bedrooms. The property also has off street parking and a garage and is offered to the market with no onward chain.

The property is within easy access of local Retail Parks and Darlington Mainline Railway Station including bus routes in and out of town.

Viewing is recommended.

Entrance Hall

Upvc double glazed window to side, access to loft via drop down ladder and radiator.

Lounge

13'10 x 11'11 (4.22m x 3.63m)

Upvc double glazed bow window to front, gas fire in surround and radiator

Kitchen/Diner

16'2 x 15'4 (4.93m x 4.67m)

Upvc double glazed windows to side and rear, fitted with wall, base and drawer units and stainless steel sink with mixer tap. Gas hob with extractor over and oven. Three is space for a fridge freezer, radiator and sliding doors to rear.

Bedroom One

11 x 10'11 (3.35m x 3.33m)

Upvc double glazed window to rear, fitted wardrobes and radiator.

Bedroom Two

10'5 x 8'11 (3.18m x 2.72m)

Upvc double glazed window to rear and radiator.

Shower Room

Upvc double glazed obscure window to side, shower cubicle, w.c, wash hand basin and radiator.

Externally

To the front is a gated generous driveway with access to garage and rear garden.

To the rear there are delightful patio and allotment areas, as well as a Summer House. There are well established borders.

Tenure

Freehold

Property Details

Local Authority: Darlington

Council Tax Band: B

Annual Price:: £1,757

Conservation Area: No

Flood Risk: Very low

Floor Area: 0 ft 2 / 0 m 2

Plot size: 0.12 acres

Mobile coverage

EE

Vodafone

Three

O2

Broadband

Basic

7 Mbps

Superfast

56 Mbps

Ultrafast

9000 Mbps

Satellite / Fibre TV Availability

BT

Sky

Note

IMPORTANT NOTE TO PURCHASERS: We endeavour to make our sales particulars accurate and reliable, however, they do not constitute or form part of an offer or any contract and none is to be relied upon as statements of representation or fact. The services, systems and appliances listed in this specification have not been tested by us and no guarantee as to their operating ability or efficiency is given. All measurements have been taken as a guide to prospective buyers only, and are not precise. Floor plans where included are not to scale and accuracy is not guaranteed. If you require clarification or further information on any points, please contact us, especially if you are travelling some distance to view. Fixtures and fittings other than those mentioned are to be agreed with the seller. We cannot also confirm at this stage of marketing the tenure of this house

GROUND FLOOR

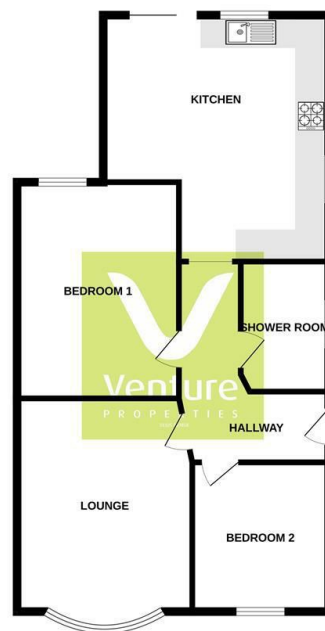

Whilst every attempt has been made to ensure the accuracy of the floorplan contained here, measurements of doors, windows, rooms and any other parts are approximate and no responsibility is taken for any error, omission or misstatement. This plan is for illustrative purposes only and should be used as such by any prospective purchaser. The services, systems and appliances shown have not been tested and no guarantee as to their operability or efficiency can be given.
Made with floorplan 02025

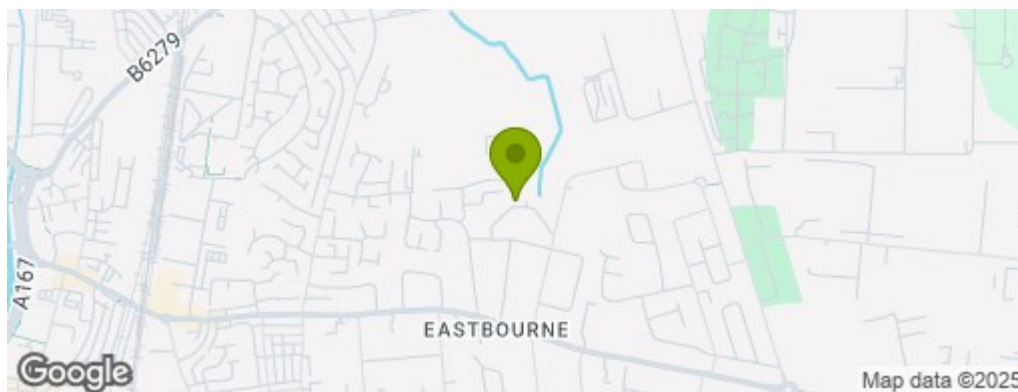

Property Information

01325 363858

45 Duke Street, Darlington, County Durham, DL3 7SD
sales@venturepropertiesuk.com